



VMG LIGNUM

Synergy between
EFFICIENCY & SUSTAINABILITY



VMG LIGNUM



**Laminated
Veneer Lumber
(LVL)**
directly from
the European
manufacturer

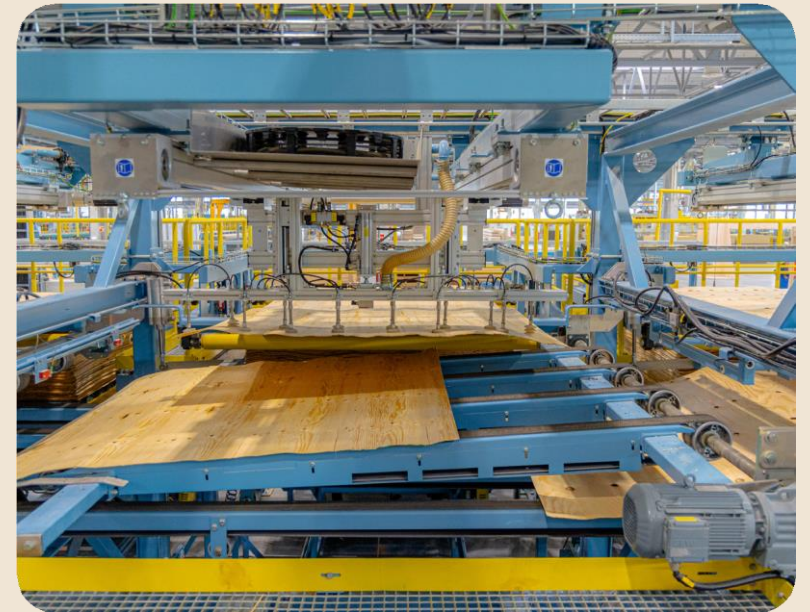



OUR LVL FACTORY IS LOCATED IN EUROPE, IN LITHUANIA.

Total land area where our factory is located:

10 ha

Production and warehouse space:

29 000 m²

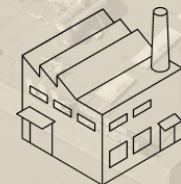

Factory:
Ryto g. 4, Menčių km.,
Naujosios Akmenės kaimiškoji sen.,
Akmenės raj., LT-85271, Lithuania

THE TWO LARGEST PORTS OF THE BALTIC STATES ARE NEARBY

To the port of Klaipėda: **160 km**

To the port of Riga: **140 km**

BALTIC SEA





**WE DELIVER PRODUCTS TO
OUR CLIENTS WORLDWIDE**

The products manufactured by us are exported to countries
in the EU, USA, and Australia.

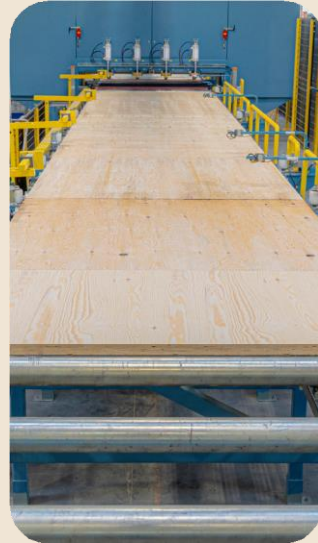



IN-HOUSE MANUFACTURING

We produce extremely large quantities of products quickly.

HIGHEST-QUALITY EQUIPMENT

We use highest-quality
equipment from well-known
manufacturers.

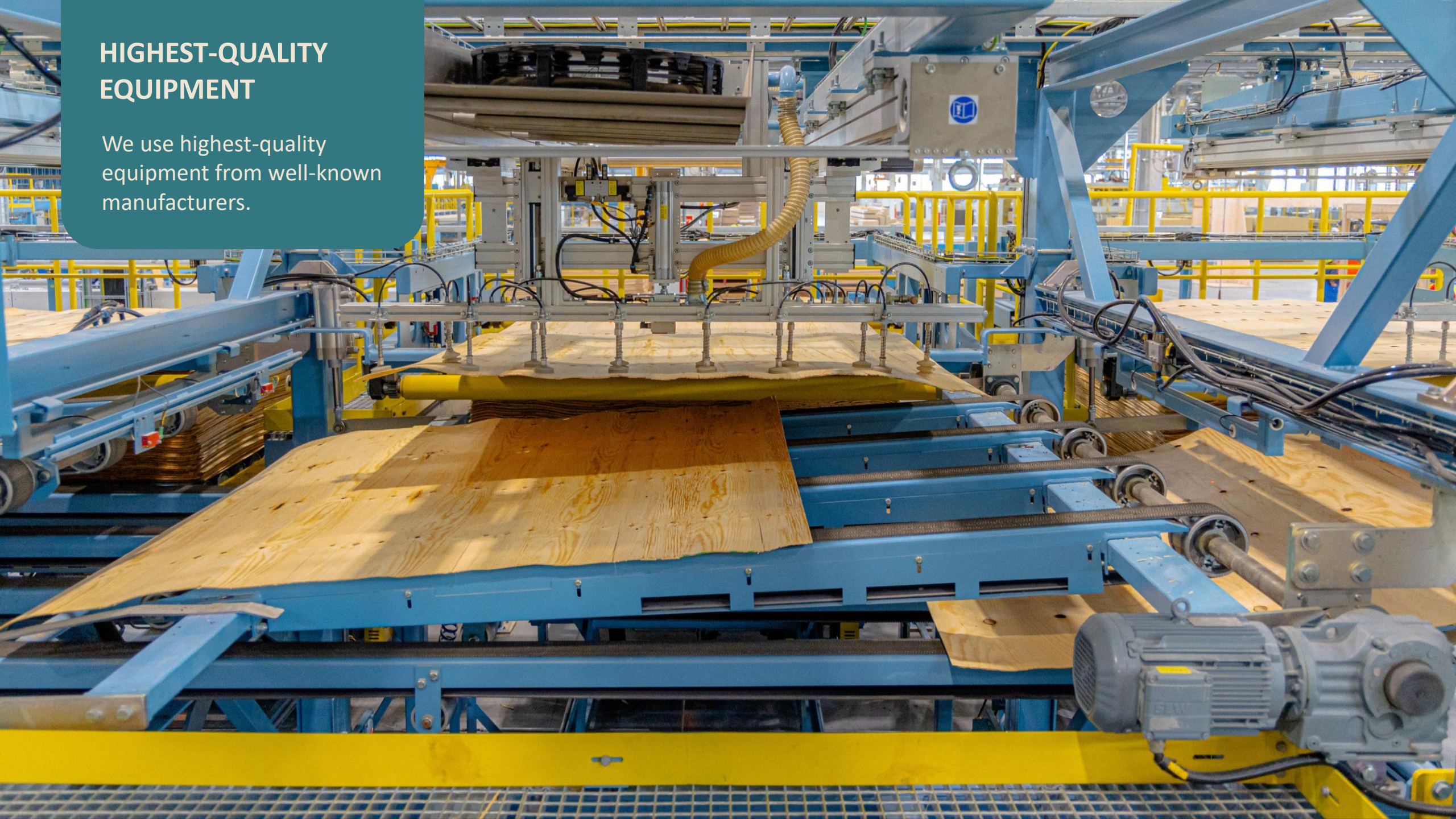



HIGHLY AUTOMATED HIGH-SPEED PRODUCTION LINES

We manufacture products with extremely accurate dimensions and ensure just-in-time production.



PARTICLE BOARD FACTORY:

Ryto g. 4, Menčių km.,
Naujosios Akmenės kaimiškoji sen.,
Akmenės raj., LT-85271, Lithuania

LVL AND I-JOIST FACTORY:

Ryto g. 6, Menčių km.,
Naujosios Akmenės kaimiškoji sen.,
Akmenės raj., LT-85271, Lithuania

OUR FACTORY PRODUCTION CAPABILITIES:

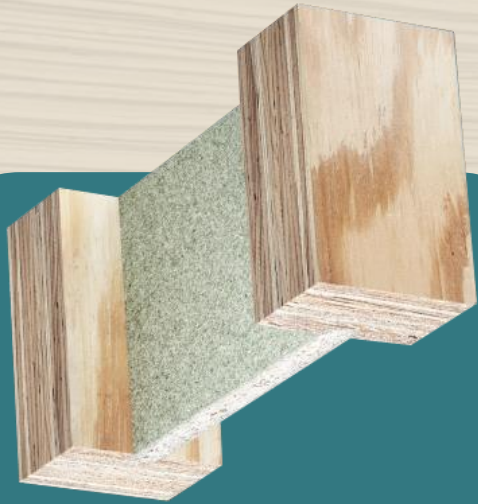

I-JOIST

15 000 000 m/year



LVL

120 000 m³/year

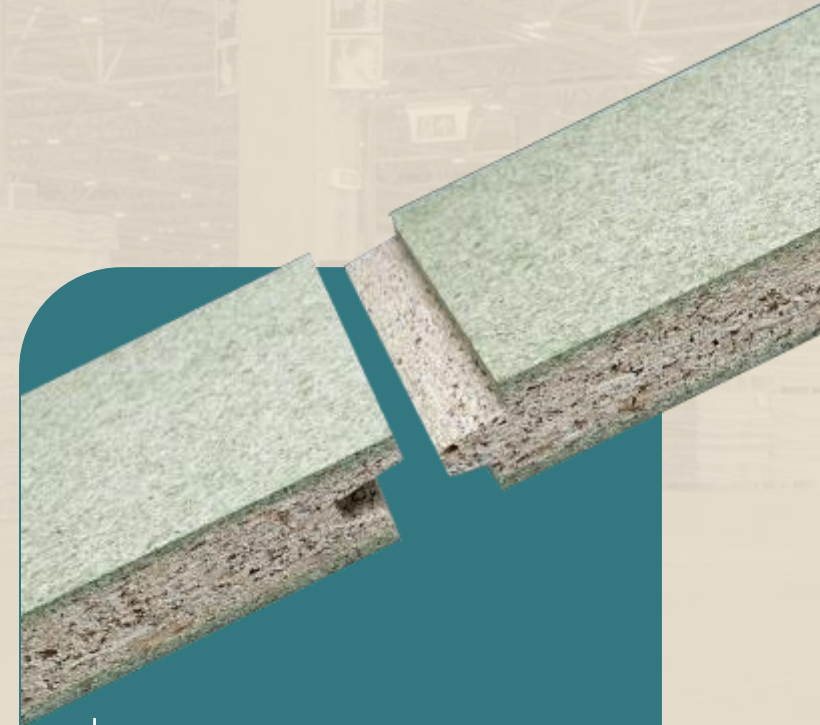

PARTICLE BOARD

200 000 m³/year



All our VMG LIGNUM LVL products are certified and made from sustainably sourced wood.

The wood we use is purchased only from verified suppliers who meet all FSC® requirements. All our wood base products are FSC® certified.

**WE ARE FLEXIBLE IN LVL
PRODUCTS MEASUREMENTS AND
QUANTITIES.**



**OUR LVL CAN BE
PRODUCED IN
DIFFERENT SHAPES
DEPENDING ON WHERE
AND HOW IT WILL BE
USED.**

WE MANUFACTURE TWO TYPES OF LVL:

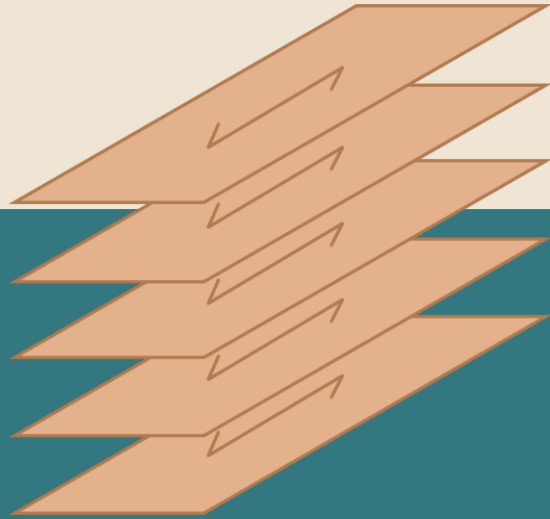

VMG LIGNUM LVL-P

(all veneers are glued parallel)

Strength class for LVL-P: P48, P35, P32

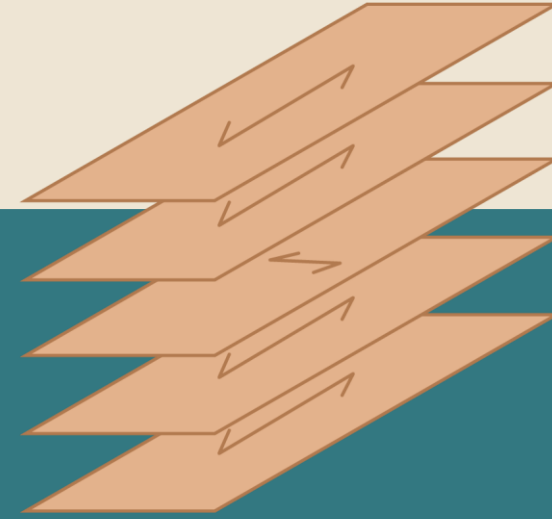

VMG LIGNUM LVL-C

(up to 20% of the veneers are cross-glued)

Strength class for LVL-C: C36, C32, C25

LVL-P is characterized by greater strength and stiffness along the longitudinal axis, while LVL-C is stronger perpendicular to the fiber. LVL-P is more suitable for beams, studs and columns, and LVL-C for slabs, lintels.

VMG LIGNUM LVL-P AND VMG LIGNUM LVL-C

MARGINAL DIMENSIONS:

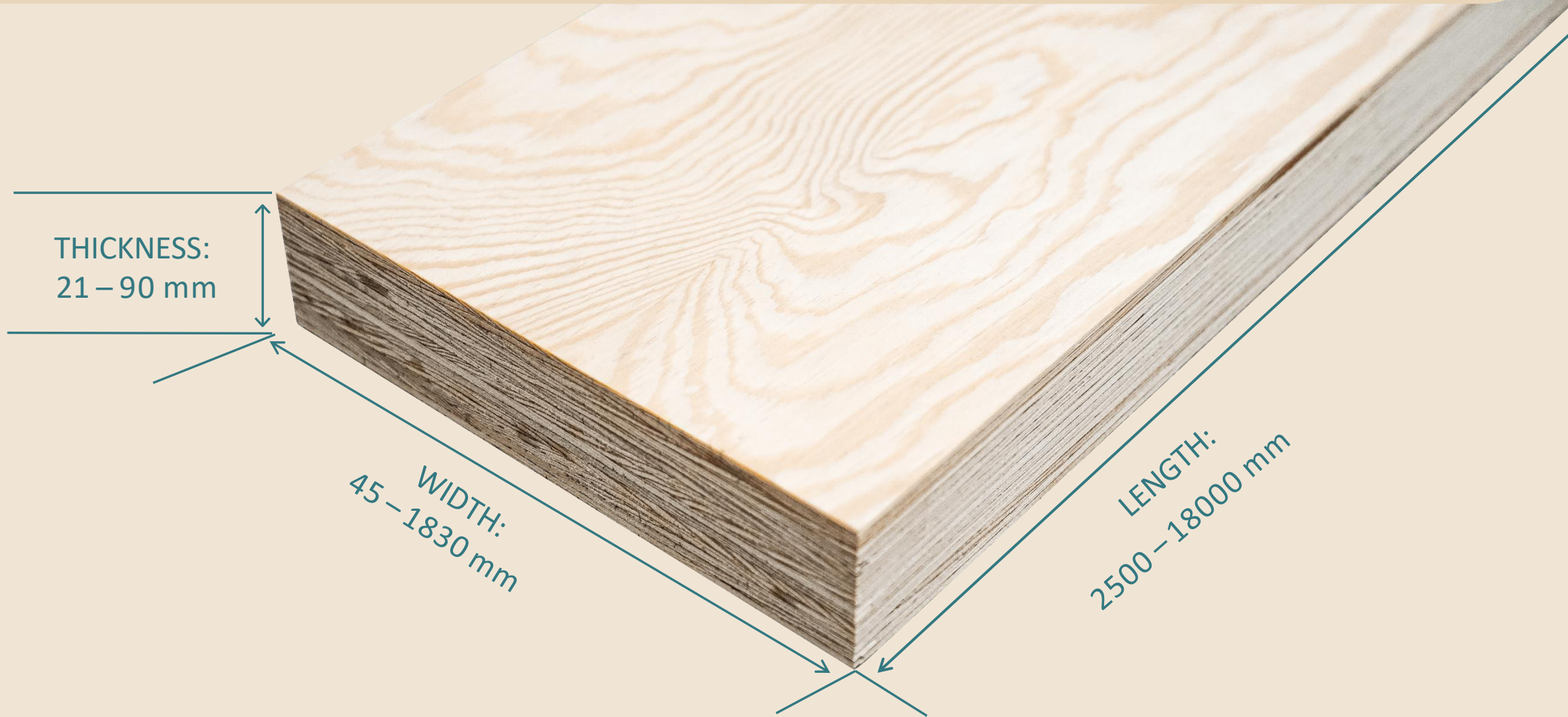

TO PRODUCE LVL IS USED:

- LVL-P: PINE WOOD
- LVL-C: PINE WOOD

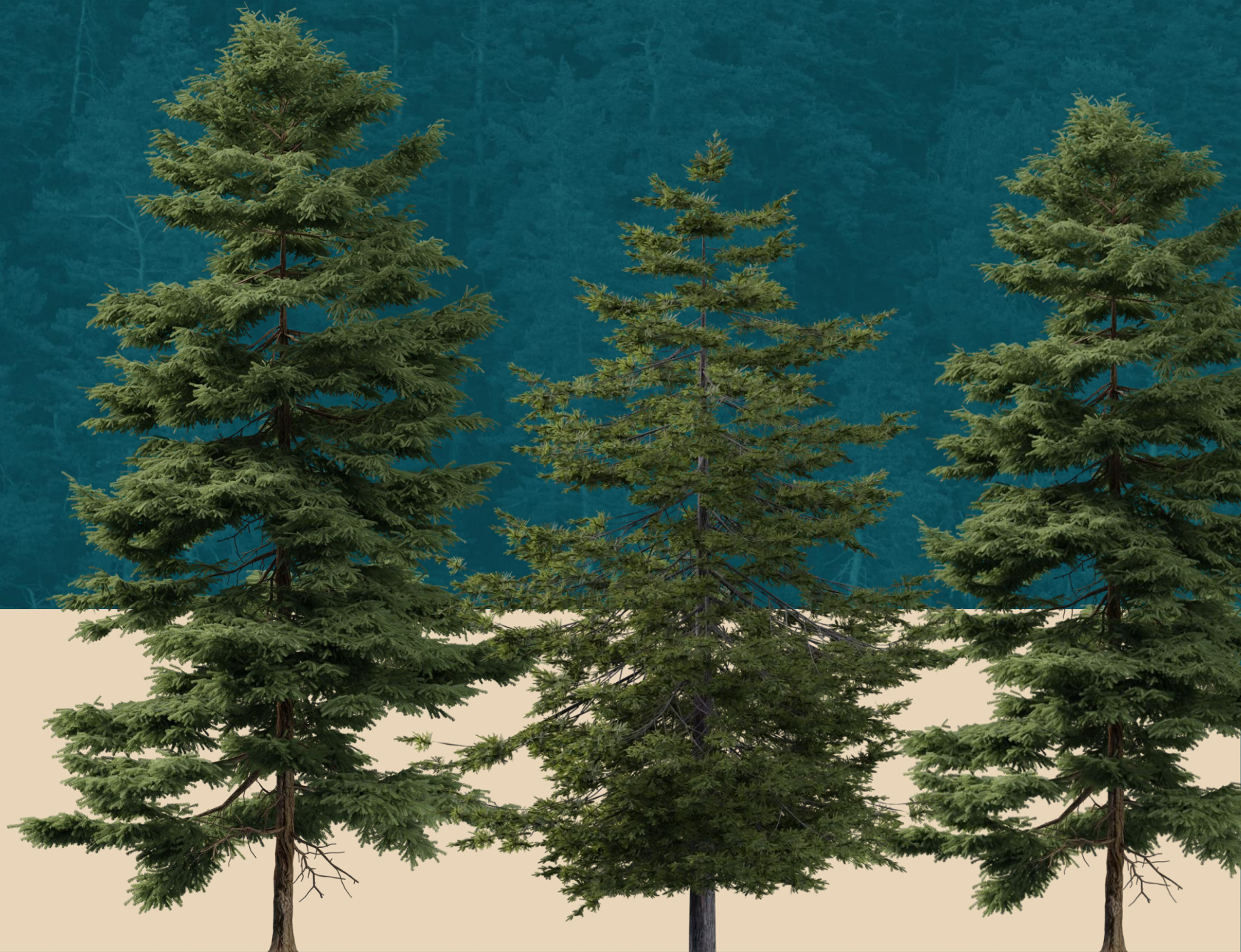

BENEFITS OF VMG LIGNUM LVL:



Available in lengths up to 18 m



Easy to handle and simple to install



Provides the consistent shape and sizes



Stronger, and straighter than traditional sawn timber



Offers superior dimensional stability, better performance and longer spans



Can be produced in different shapes depending on where and how it will be used



Tolerant of holes and notches



One of the strongest wood-based construction materials relative to its density



Has the great advantage of using wood resources efficiently and sustainably

VMG LIGNUM LVL-P LAYERS OF VENEER LUMBER:

Thickness, mm	Number of veneer layers	Veneer structure
21	7	
24	8	
27	9	
30	10	
33	11	
39	13	
42	14	
45	15	
48	16	
51	17	
57	19	
63	21	
69	23	
75	25	

LVL-P is made of 3 mm veneers

VMG LIGNUM LVL-C LAYERS OF VENEER LUMBER:

Thickness, mm	Number of veneer layers	Veneer structure
21	7	I-III-I
21	7	II-I-II
24	8	II-II-II
27	9	II-III-II
30	10	II-III-I-II
33	11	II-III-I-II
39	13	II-III-III-II
45	15	II-III-III-II
51	17	II-III-III-III-II
57	19	II-III-III-III-II
63	21	II-III-III-III-II
69	23	II-III-III-III-II
75	25	II-III-III-III-II

LVL-C is made of 3 mm veneers

STANDARD VMG LIGNUM LVL PROCESSING:

VMG LIGNUM LVL can be further processed by the customer in various ways according to the intended use and specific customer wishes.

PROCESSING

DESCRIPTION

Impregnation

Not impregnated

Anti-termites'
treatment

Only for glue, the
surface is untreated

Sanding

Surfaces are sanded,
edges are not sanded

CNC cutting

No cutting

Other cuts

Cutting to lengths
and widths

WE ARE SUITABLE FOR LOW, MEDIUM AND LARGE-SCALE PRODUCTION PROJECTS

Our factory production capabilities:
LVL: 120 000 m³/year

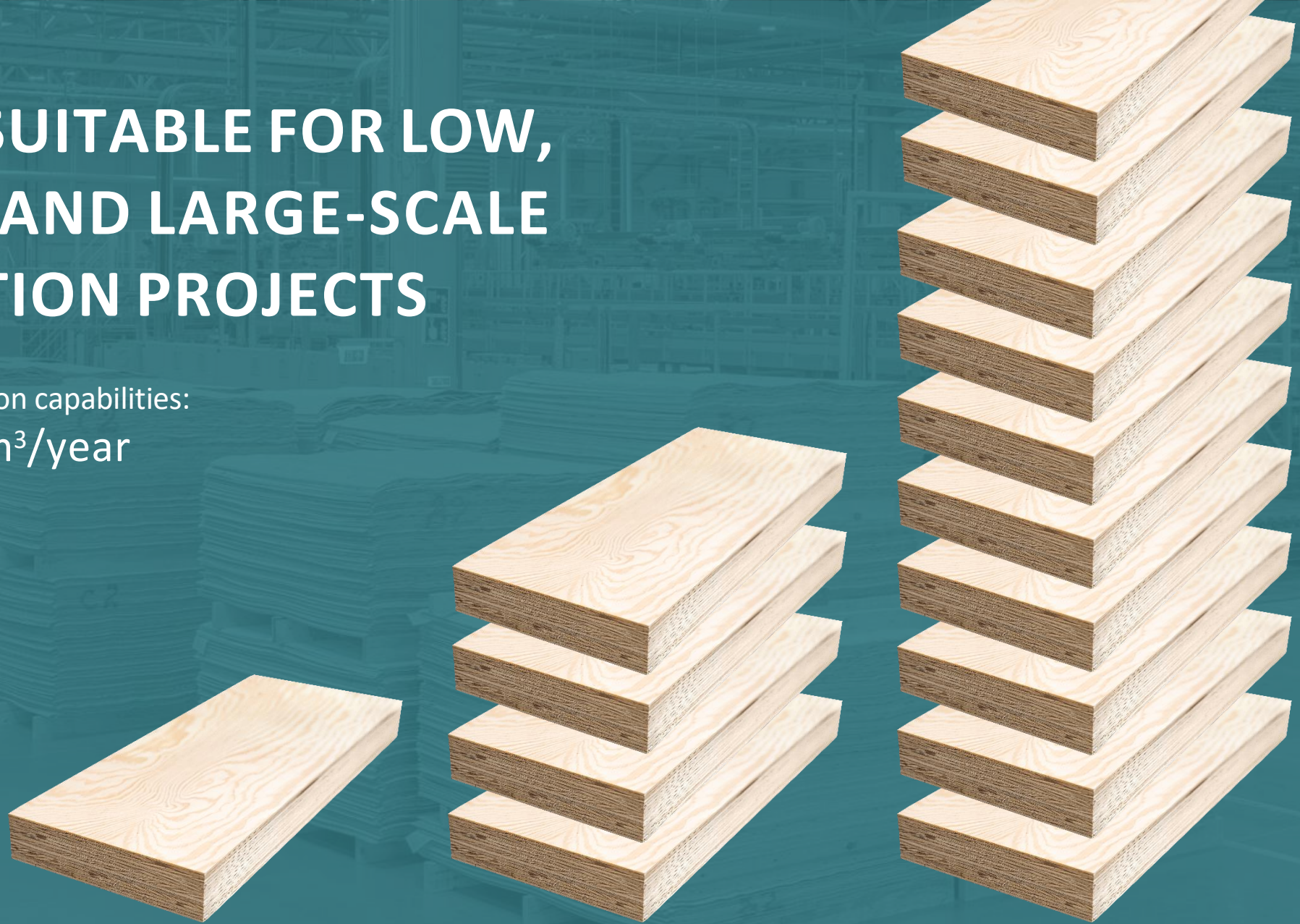

OUR ENGINEERED WOOD PRODUCTS ARE USED IN:



residential
construction
projects



commercial
construction
projects



government
construction
projects



public
construction
projects

WE ALSO SUPPLY LVL:



for interior products
(e.g. stairs, doors)



for furniture (e.g. bed
frames)



scaffolding



for concrete
formwork



for bridges



for engineering and
infrastructure structures
(e.g. wind farms)

VMG LIGNUM LVL IS SUITABLE FOR ALL TYPES OF TIMBER BUILDINGS STRUCTURES:

for structures and trusses

for wall structures
(wall boards, studs, frames and lintels)

for roof structures
(roof rafters, self load bearing panels, consoles)

for floor structures (beams, floor boards)

for special buildings and infrastructure

IN A SINGLE-FAMILY BUILDING, VMG LIGNUM LVL IS USED FOR:

- ① wall studs (LVL-P)
- ② roof rafters (LVL-P/C)
- ③ rim boards (LVL-P/C)
- ④ floor joists (LVL-P)
- ⑤ columns (GLVL)
- ⑥ ridge beams (LVL-P)
- ⑦ floor beams (LVL-P)
- ⑧ bracing panels (LVL-C)
- ⑨ floor panels (LVL-C)
- ⑩ roof panels (LVL-C)
- ⑪ lintels (LVL-C/P)
- ⑫ ledger beams (LVL-C/P)
- ⑬ parapet walls(LVL-P/C)

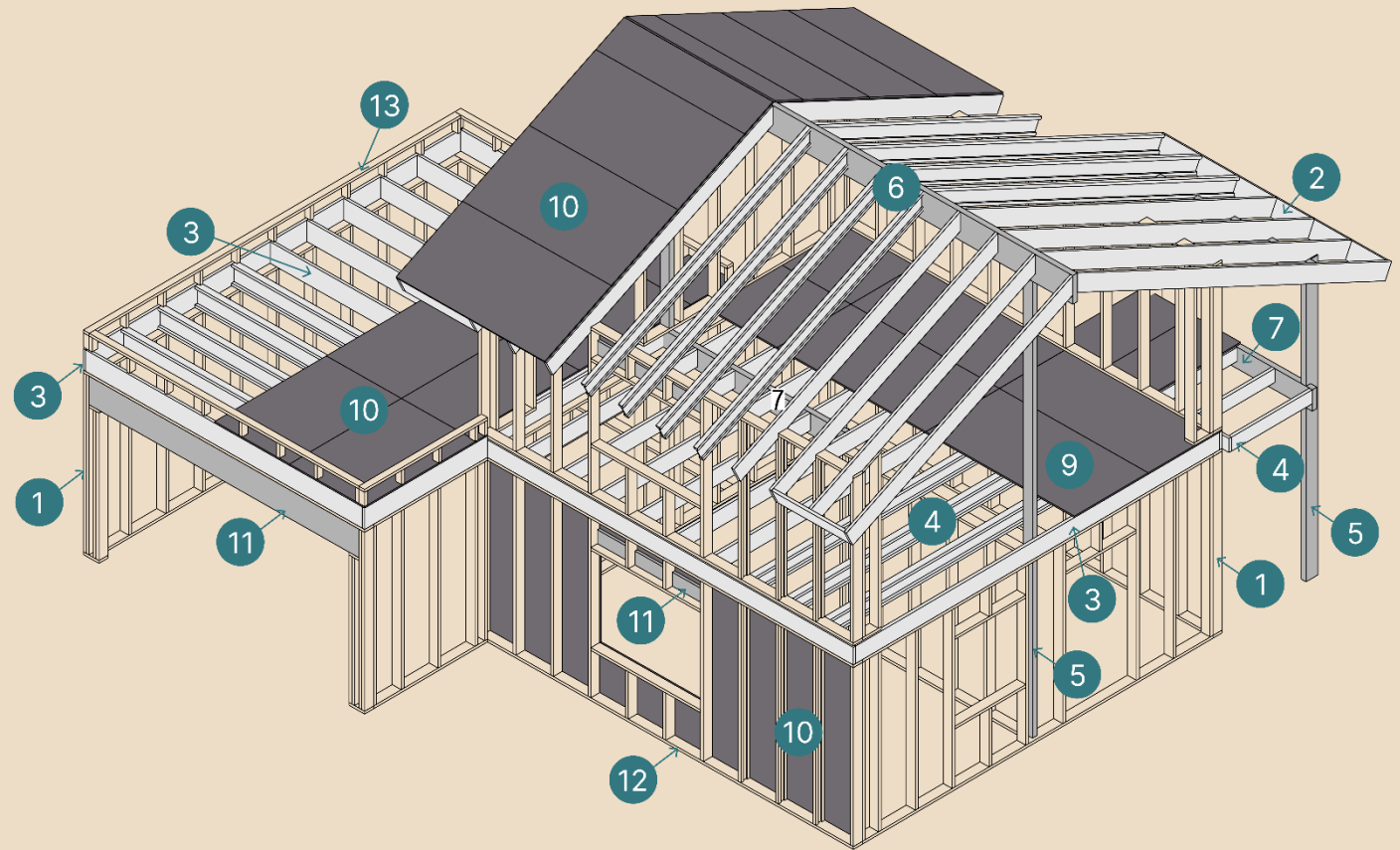

Application of VMG LIGNUM LVL in an single-family building

IN A MULTI-STOREY BUILDING, VMG LIGNUM LVL IS USED FOR:

- ① wall studs (LVL-P)
- ② roof beams (LVL-P)
- ③ rim board (LVL-P/ C)
- ④ floor beams (LVL- C/P)
- ⑤ ⑩ stiffness plate/wall plates (LVL-C)
- ⑥ corridor floor slabs (LVL-C)
- ⑦ roof panels (LVL-C)
- ⑧ lintels (LVL-P/C, GLVL)
- ⑨ ledger beams (LVL-P/C, GLVL)
- ⑩ bathroom module structure/wall plates (LVL-C), elevator shaft plates (LVL-C)
- ⑪ RIB floor panels (LVL-P/C, GLVL)
- ⑫ balcony floor/ roof panels (LVL-C)

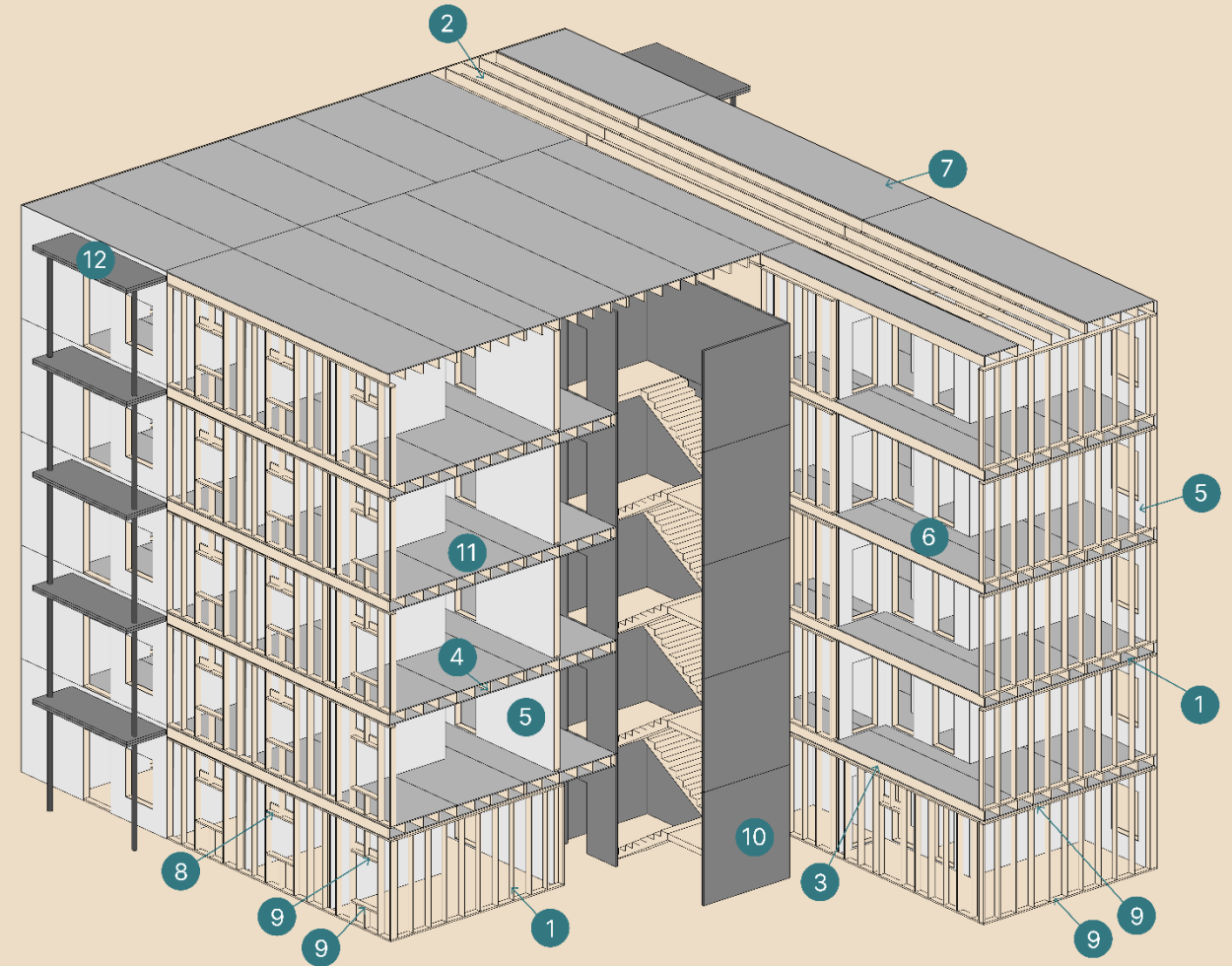

Application of VMG LIGNUM LVL in a multi-story buildings

IN INDUSTRIAL, STORAGE, SPORTS, AND SIMILAR BUILDINGS, LVL CAN BE USED AS:

- ① portal frames (LVL-P/C)
- ② truss elements (LVL-P/C)
- ③ columns (LVL-P)
- ④ one and more span purlins (LVL-P)
- ⑤ lintels (LVL-P/C)
- ⑥ bracing panels for walls (LVL-C)

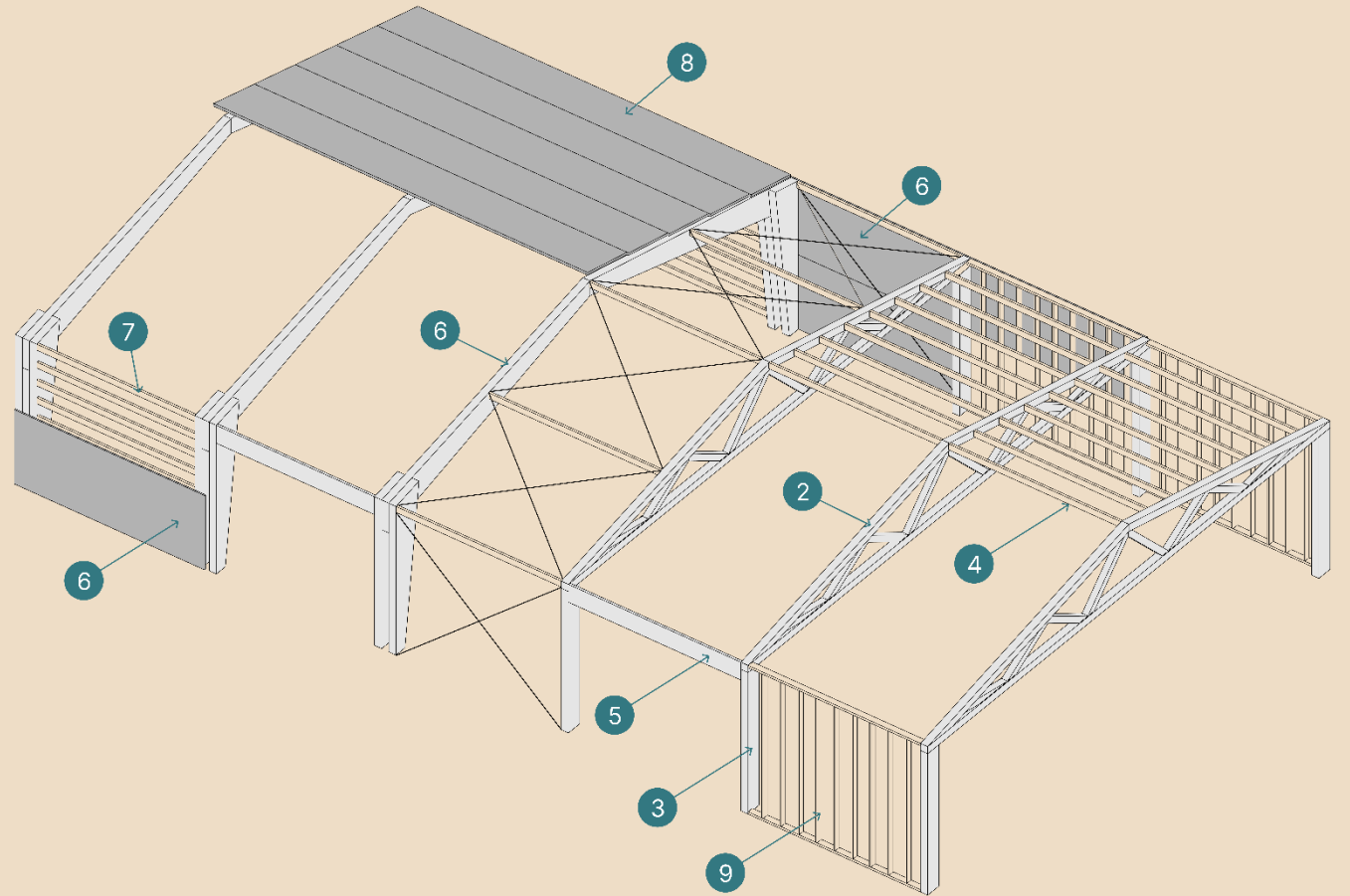

Application of VMG LIGNUM LVL in industrial buildings

WHAT YOU CAN EXPECT FROM WORKING WITH US:

↳ Quick response to your inquiries

Technical support and guidance across all project phases ←

↳ Focus on meeting the very toughest your requirements

Manufacturing speed and flexibility ←

↳ On-time product delivery

Support throughout the entire project lifecycle ←

WE ALWAYS READY TO WALK THE EXTRA MILE!

**WE KINDLY INVITE YOU TO
CONTACT US WITH ANY
QUESTIONS REGARDING
OUR PRODUCTS OR NEW
PROJECTS.**



LVL and I-JOIST factory:

Ryto g. 6, Menčių km.,
Naujosios Akmenės kaimiškoji sen., Akmenės raj.,
LT-85271, Lithuania

ARNAS JANUŠKA

Sales Manager

+370 616 98905

arnas.januska@vmg.eu

www.vmg-lignum.eu